



78 Dalyell Way Raymond Terrace NSW

3 1 2

PRICE REDUCED! Ideally located in Riverview Ridge amongst quality homes. The added bonus of no rear neighbour's except the deer!

Features:

- * 3 bedrooms all with built-ins
- * Main bedroom has ensuite access to bathroom and walk-in robe
- * Spacious formal lounge to front of house with RC/AC
- * Modern kitchen with dishwasher
- * Combined family/meals area that opens onto a huge aluminium covered entertainment area that wraps around the side and rear of house
- * Separate toilet
- * Double garage with drive thru access
- * Generous sized yard with plenty of room for a shed or

Price : \$ 620,000
Land Size : 609 sqm
View : <https://www.dowlingterrace.com.au/sale/ns-w/port-stephens/raymond-terrace/residential/house/7293917>



Kim Hammond
0498 990 064

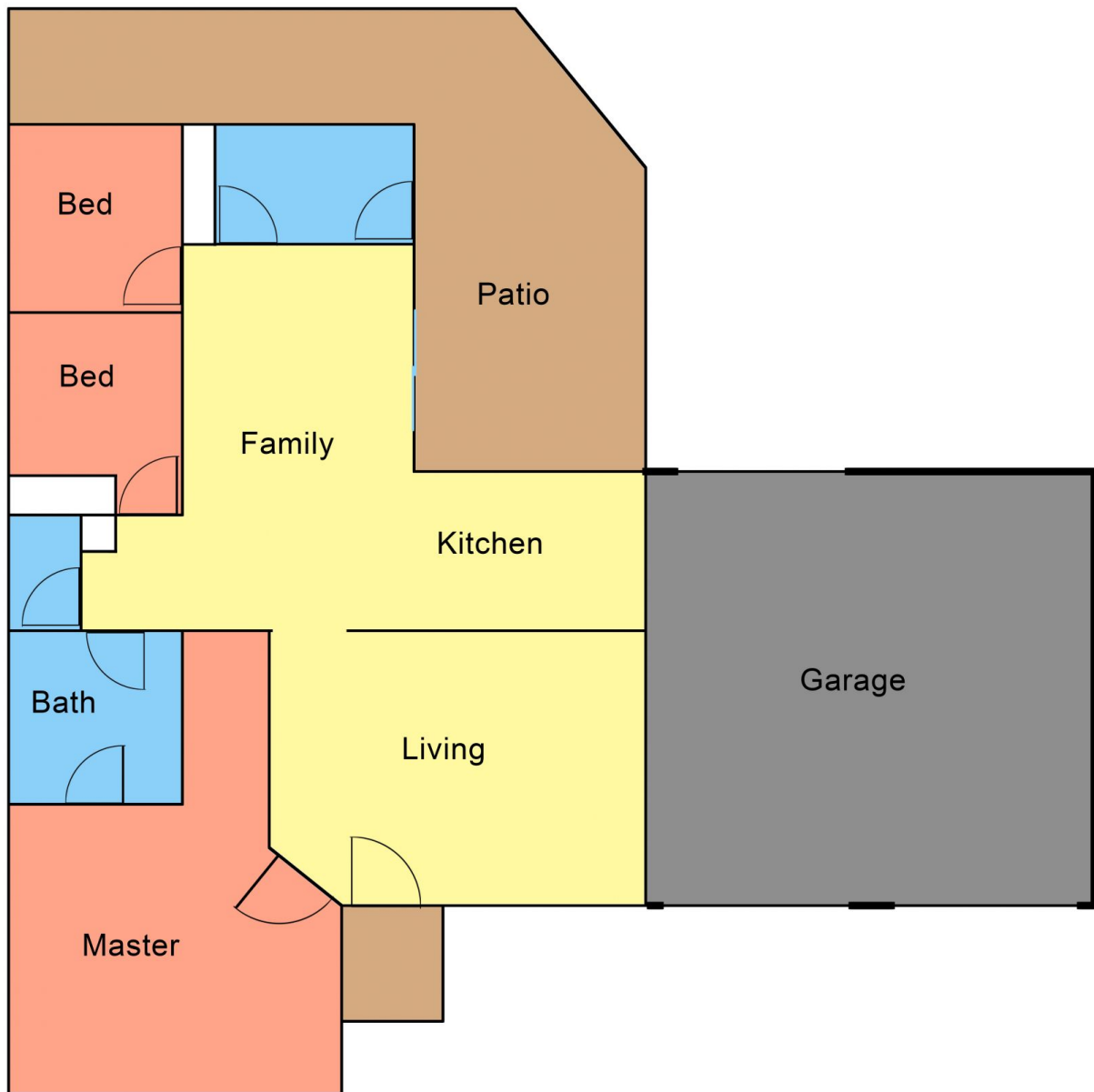

THIS FLOORPLAN IS PROVIDED WITHOUT WARRANTY OF ANY KIND. SENSOPIA DISCLAIMS ANY WARRANTY INCLUDING, WITHOUT LIMITATION, SATISFACTORY QUALITY OR ACCURACY OF DIMENSIONS.