



## 18 Green Slopes Drive Raymond Terrace NSW

3 2 1

Will consider all genuine offers! A fabulous floor plan with parents retreat at one end of this meticulously presented home and the oversized kids bedrooms at the other end. The 3rd bedroom is bigger enough to convert into two bedrooms. On a corner block, there's enough room to install 2 carports if you need the extra car space.

### Features:

- \* 3 oversized bedrooms with built-in robes
- \* The main bedroom has ensuite, walk-in robe and RC/AC
- \* Spacious combined lounge and dining room
- \* Open planned casual dining & family room with RC/AC
- \* Kitchen offers plenty of cupboard space along with gas cooktop, wall oven & dishwasher
- \* All in one main bathroom and spacious laundry
- \* Large tiled entry foyer
- \* Partially enclosed back verandah

**Land Size** : 643 sqm  
**View** : <https://www.dowlingterrace.com.au/sale/nsw/port-stephens/raymond-terrace/residential/house/7294619>



**Craig Higgins**  
02 4987 2226



**Kim Hammond**  
0498 990 064

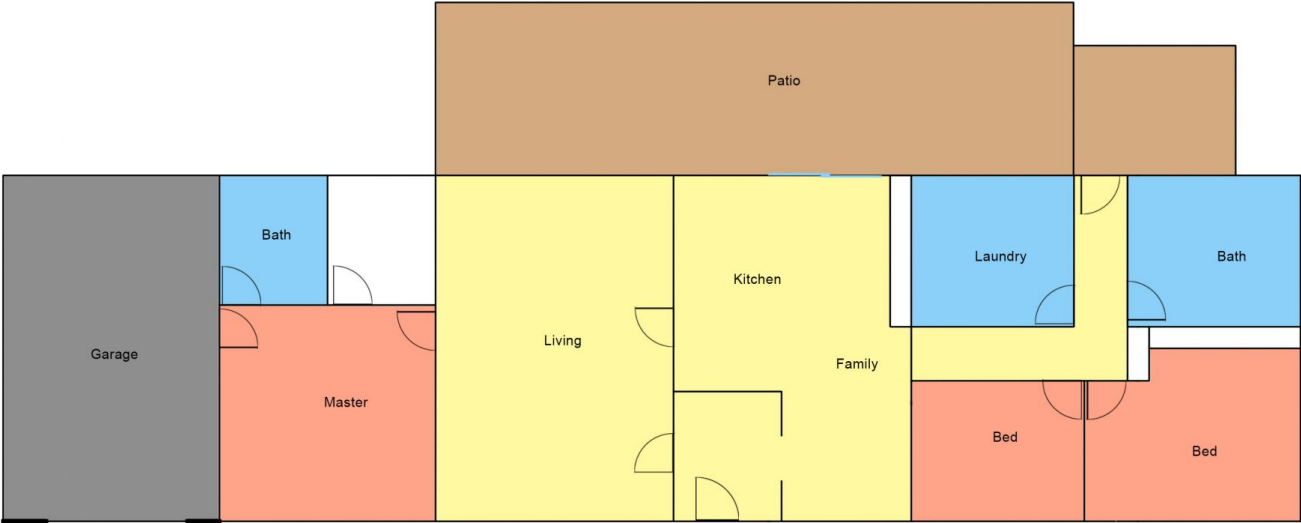

**Disclaimer**  
This floor and site plan including fixtures, furniture, measurements and dimension are approximate and for illustrative purposes only. This floor plan gives no guarantee, warranty or representation of accuracy and layout. All enquiries must be directed to the agent or party representing this floor plan.