

# DOWLING

PROPERTY



## 16 Gordon Reeve Close Raymond Terrace NSW

5  2  2 

If peace & quiet are important to you, then come & inspect this beautifully presented home tucked away in a quiet little cul-de-sac with walking and cycling tracks nearby for an easy escape to nature. Generous dimensions ensure your large-scale pieces will be right at home here.

Features:

Large tiled entry

A separate wing incorporates lounge room and large guest bedroom with bay windows. A brilliant opportunity to create a work space away from the rest of the home

Tiled family room & spacious kitchen with gas cook-top, breakfast bar, double pantry and double oven

Sun filled living room at rear of home with RC/AC & bay windows

Master retreat with bay window is large enough to accommodate a reading nook

**Price** : \$ 795,000

**Land Size** : 918 sqm

**View** : <https://www.dowlingterrace.com.au/sale/nsw/port-stephens/raymond-terrace/residential/house/7294644>



**Kim Hammond**  
0498 990 064

<https://www.dowlingterrace.com.au>

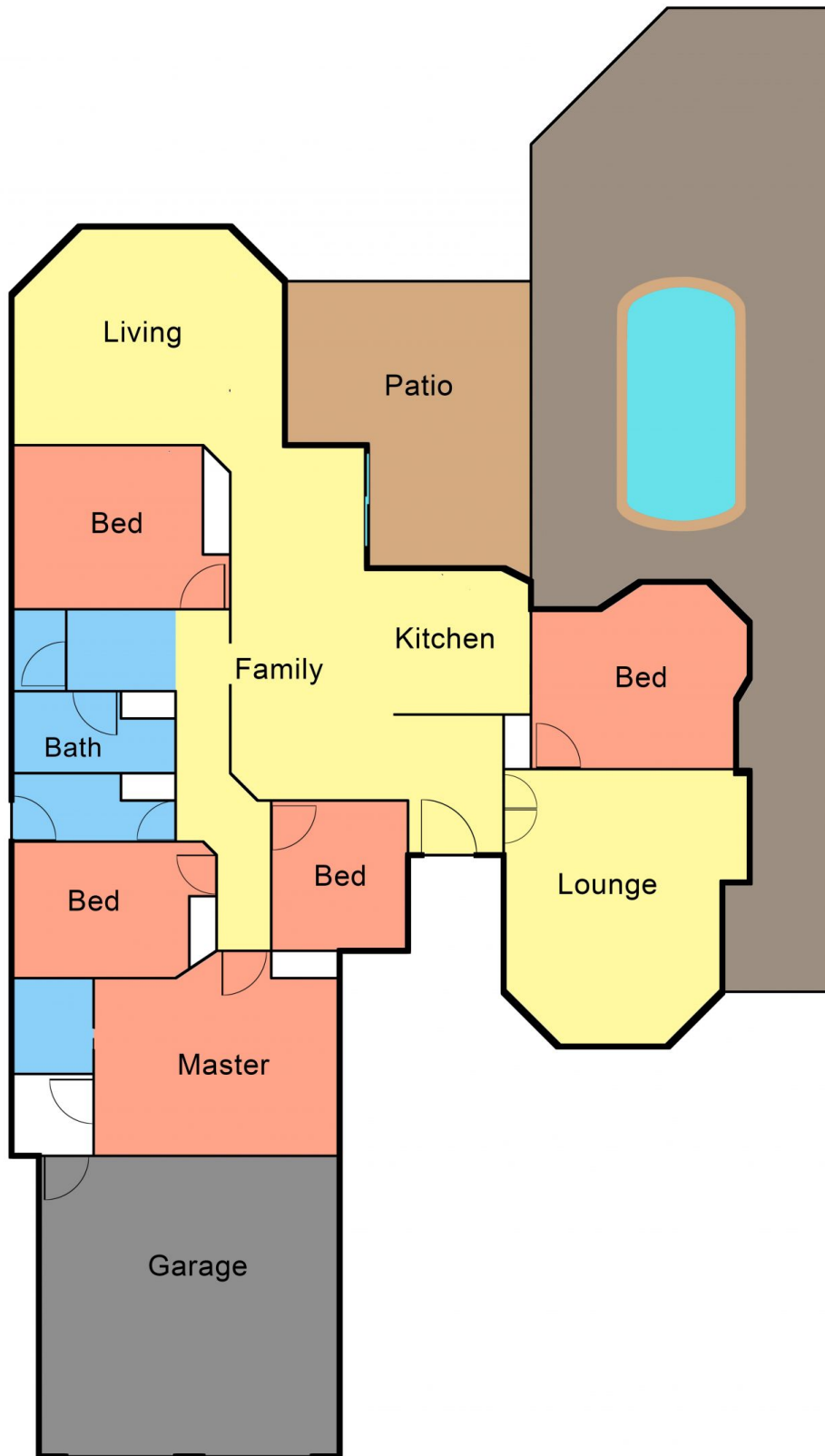

**Disclaimer**

This floor and site plan including fixtures, furniture, measurements and dimension are approximate and for illustrative purposes only. This floor plan gives not guarantee, warranty or representation of accuracy and layout. All enquiries must be directed to the agent or party representing this floor plan