



## 14 Cederwood Crescent Raymond Terrace NSW

3 1 2

Ideally located in the "Grove Estate" this home would suit both the investor or First Home Buyer. Offers a generous sized yard with vehicular access to the rear that's ideal for the van or boat etc

**Land Size** : 708 sqm  
**View** : <https://www.dowlingterrace.com.au/sale/ns-w/port-stephens/raymond-terrace/residential/house/7300634>

### Features:

- \* 3 bedrooms all with built-in robes, mirrored to main
- \* Tiled entry
- \* Formal lounge to front of home
- \* Separate formal dining that could be converted to a study or 4th bedroom
- \* Spacious family room off kitchen
- \* Kitchen with plenty of bench and cupboard space
- \* Paved outdoor area
- \* Double garage with internal access



**Craig Higgins**  
02 4987 2226

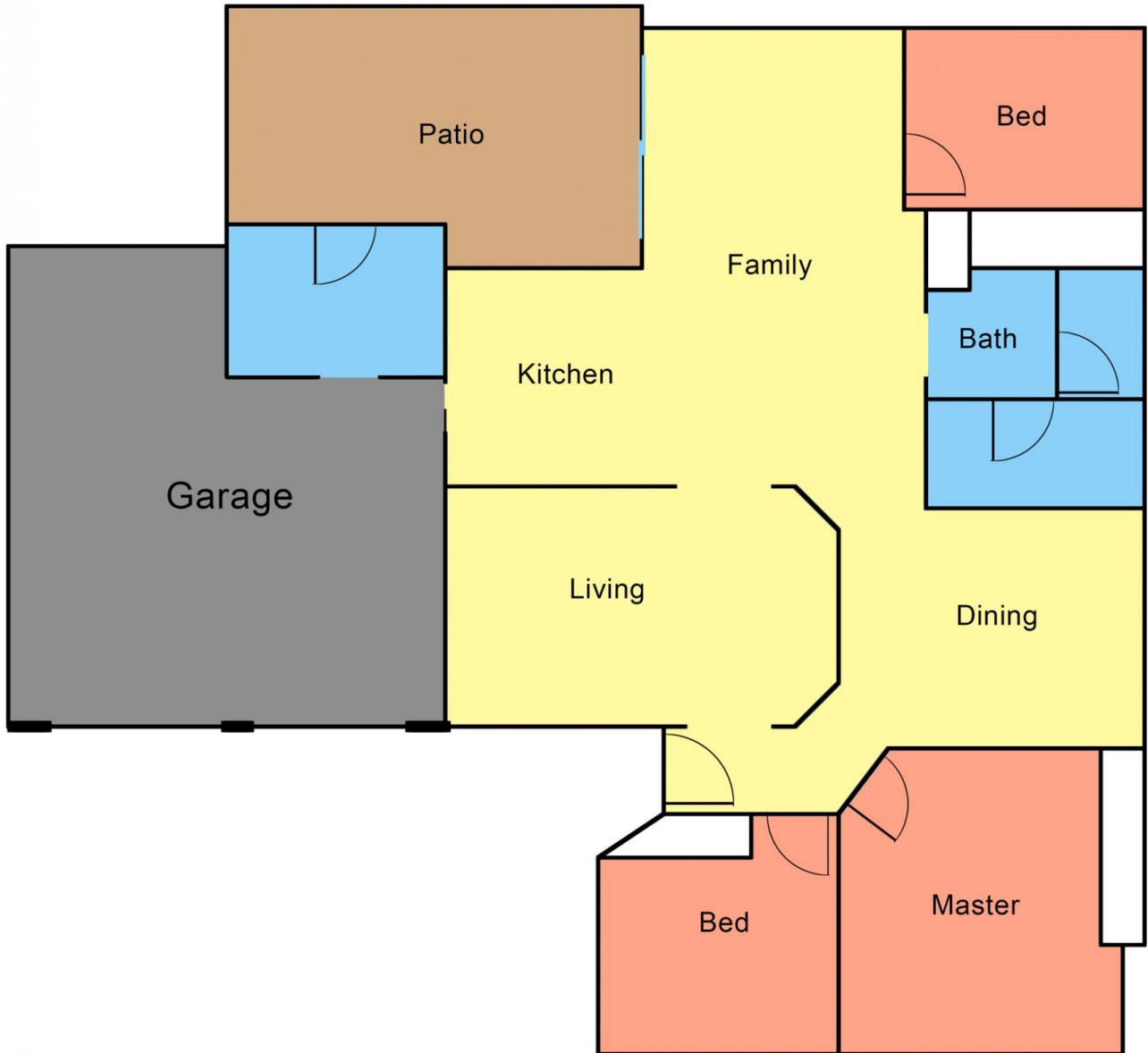

**Disclaimer**

This floor and site plan including fixtures, furniture, measurements and dimension are approximate and for illustrative purposes only. This floor plan gives not guarantee, warranty or representation of accuracy and layout. All enquiries must be directed to the agent or party representing this floor plan