



## 5 Shearman Avenue Raymond Terrace NSW

3 1 1

Finishes of light colours and warm woods lighten and brighten this well presented cottage. With freshly polished floorboards and freshly painted both inside and out, you can move straight in or lease out! Estimated rent is \$450 per week.

### Features:

- 3 bedrooms with BIRS
- Combined bathroom has shower over bath, a new vanity & new toilet
- Lounge has RC/AC
- A modern bright kitchen with overhead cupboards and dining room
- Single carport & lawnlocker & side access to back yard

A low maintenance house on a very well maintained block. Located 2kms from Raymond Terrace CBD with local

**Land Size** : 601 sqm  
**View** : <https://www.dowlingterrace.com.au/sale/ns-w/port-stephens/raymond-terrace/residential/house/7347536>



**Kim Hammond**  
0498 990 064

Measurements are approximate and are to be used only as a guide



Site Plan  
Back

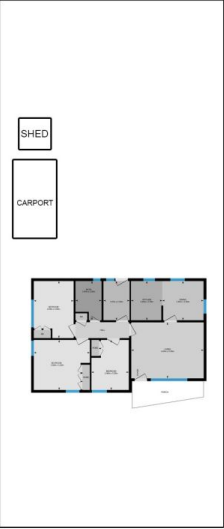

Front

**DOWLING**  
PROPERTY

5 Shearman Ave, Raymond Terrace