



## 2/5 Frost Drive Mayfield West NSW

5 🚗

High profile "FRONT UNIT" set in the prestigious Steel River Estate, freshly painted throughout with as new floor covering and ducted air to mezzanine office block. Security fencing with timed access gates featuring:

- \*228m2 total floor space
- \*181m2 ground floor with formal reception, kitchenette, Disabled size W.C & warehouse-floor plan can be varied upon application
- \*47m2 of air conditioned mezzanine offices overlooking the warehouse-offers 2 separate offices plus boardroom
- \*4.5m roller door
- \*5 reserve car parks plus additional customer car parking
- \*Security fencing with timed access gates, private control for lessee to allow access at anytime
- \*Central location close to Newcastle CBD & harbour
- \*\$39,500 rental P.A + GST

**Price** : \$39,500 pa  
**Building Size** : 228 sqm  
**View** : <https://www.dowlingterrace.com.au/lease/nsw/newcastle-region/mayfield-west/commercial/industrial/7597697>



**Gregg Bates**  
0418 416 343



**Kerri Handford**  
0459 713 558

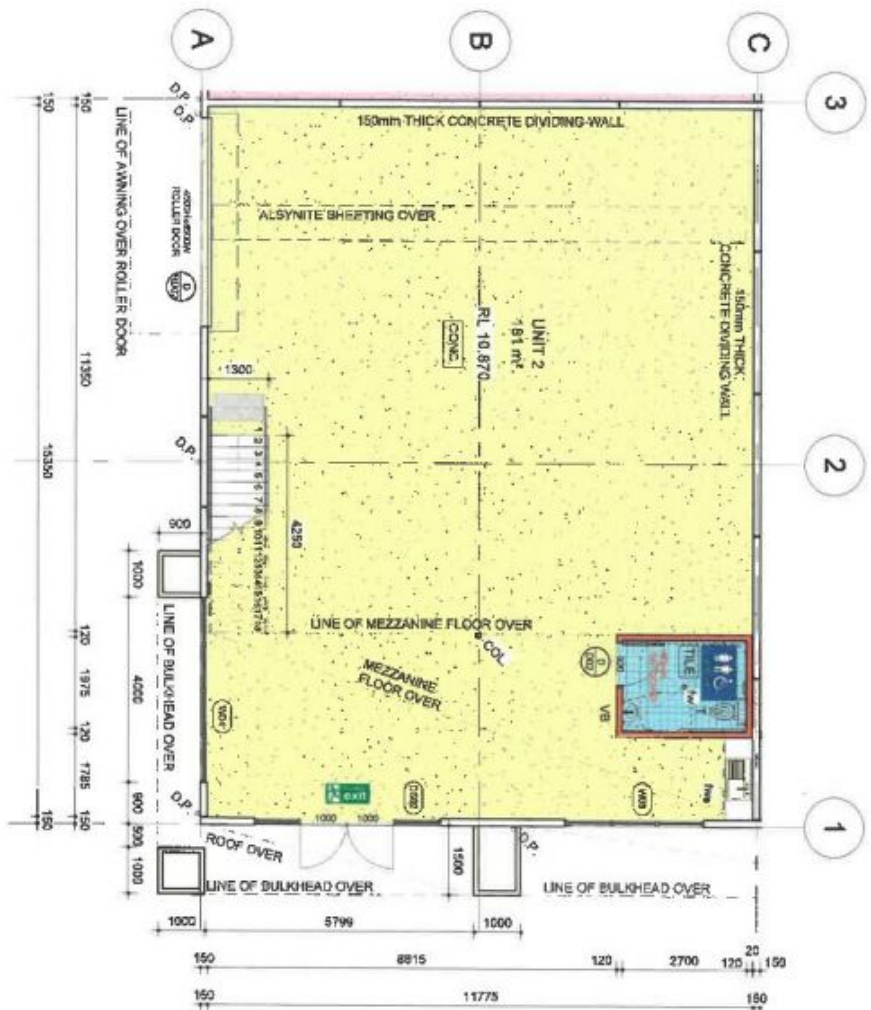

THIS DRAWING IS THE PROPERTY OF WILLIAMS RIVER STEEL. THE INFORMATION IDEAS AND CONCEPTS CONTAINED IN THE DOCUMENT ARE CONFIDENTIAL AND MAY NOT BE DISSEMINATED OR REPRODUCED WITHOUT THE EXPRESSED PERMISSION OF THE WILLIAMS RIVER STEEL GROUP OF COMPANIES.

ALL DISCREPANCIES SHALL BE REFERRED TO THE DESIGNER FOR DECISION BEFORE PROCEEDING WITH THE WORK. ALL DIMENSIONS RELAYED TO SETTING OUT AND OFF-SITE WORK SHALL BE VERIFIED BY THE CONTRACTOR BEFORE CONSTRUCTION AND FABRICATIONS COMMENCED. THE ENGINEERS DRAWINGS SHALL NOT BE SCALED.

ISSUE	DESCRIPTION	DATE
1	FOR REVIEW	26.7.2017

**WILLIAMS RIVER STEEL**  
*There is a Difference*

25 OLD PUNT ROAD, TOMAGO, NSW 2322  
PHONE: 02 49852000 FAX: 02 49852009  
EMAIL: [williams@williams.com.au](mailto:williams@williams.com.au) WEB: [www.williams.com.au](http://www.williams.com.au)  
AUSTRALIA WIDE: 1300 303 121 WEB: [www.greencastpanels.com.au](http://www.greencastpanels.com.au)

<b>MAVERICKS</b>			
LOT 65 D.P. 270249			
NO.5 FROST DRIVE STEEL RIVER			
MAYFIELD WEST NSW 2304			
<b>UNIT 2</b>			
<b>FOR REVIEW</b>			
<b>FLOOR PLAN &amp; MEZZANINE PLAN</b>			
DRAWN:	B.W.	CHECKED:	B.W.
JOB No:	JN612430	DATE:	26.7.2017
PAGE SIZE:	A3	SHEET:	A120
ISSUE:	1	SCALE:	1:100

**INDUSTRIAL • COMMERCIAL • PRE - CAST PANEL**



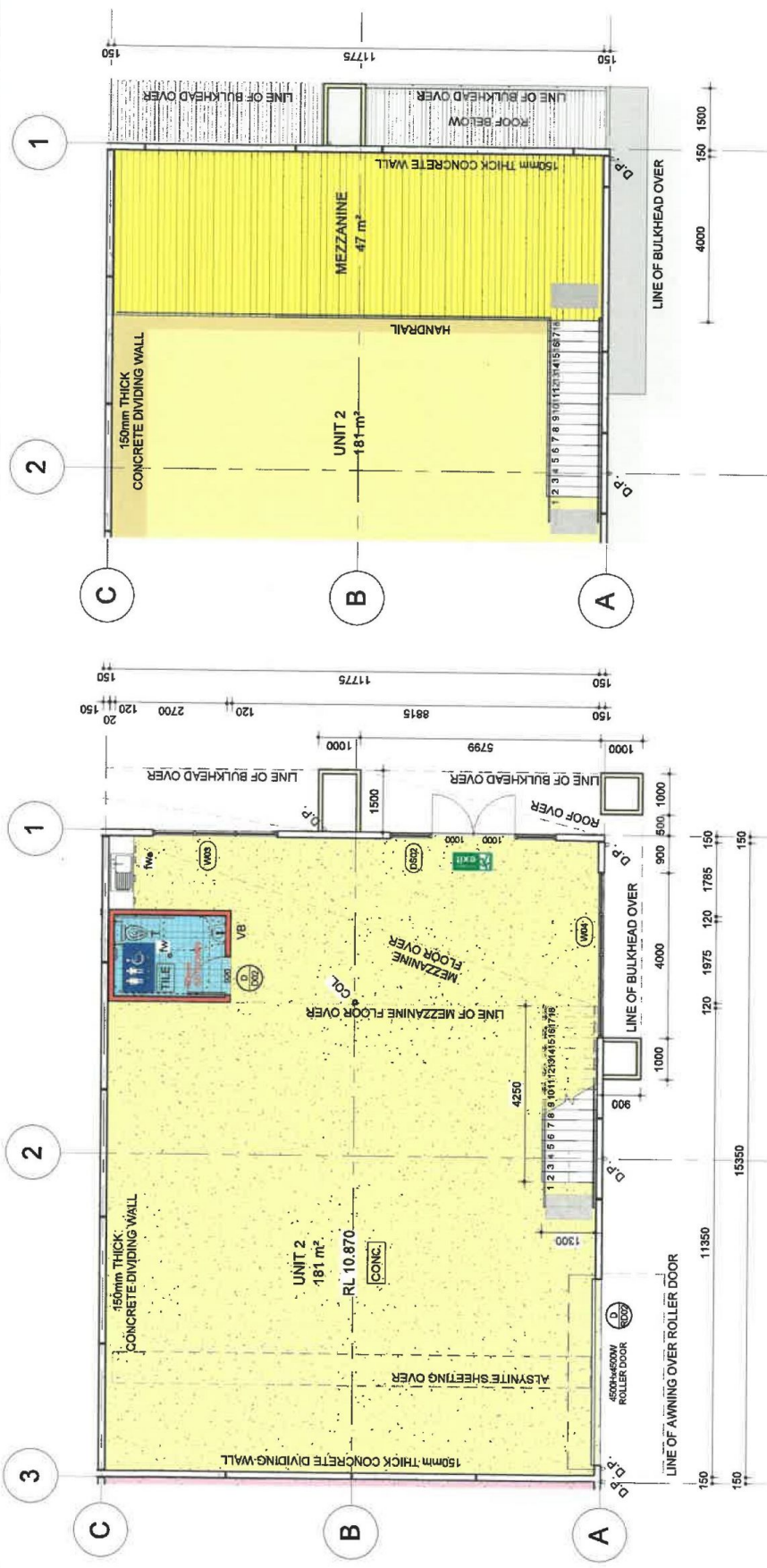

FLOOR PLAN

1 : 100

MEZZANINE PLAN

1 : 100

MAVERICKS

LOT 65 D.P.270249  
No.5 FROST DRIVE STEEL RIVER  
MAYFIELD WEST NSW 2304

UNIT 2

FOR REVIEW

FLOOR PLAN & MEZZANINE PLAN

DRAWN:	B.W.	CHECKED:	B.W.
JOB No:	JN612430	DATE:	26.7.2017
PAGE SIZE:	A3	SHEET:	A120
SCALE:	1:100	ISSUE:	1



25 OLD PUNT ROAD, TOMAGO, NSW 2322  
PHONE: 02 49852000 EMAIL: [wrtsteel@wrtsteel.com.au](mailto:wrtsteel@wrtsteel.com.au)  
FAX: 02 49852099 WEB: [www.wrtsteel.com.au](http://www.wrtsteel.com.au)  
AUSTRALIA WIDE: 1300 393 121 WEB: [www.precastpanels.com.au](http://www.precastpanels.com.au)

THIS DRAWING IS THE PROPERTY OF WILLIAMS RIVER STEEL. THE INFORMATION, IDEAS AND CONCEPTS CONTAINED IN THE DOCUMENT ARE CONFIDENTIAL AND MAY NOT BE DISTRIBUTED OR REPRODUCED WITHOUT THE EXPRESSED PERMISSION OF THE WILLIAMS RIVER STEEL GROUP OF COMPANIES

ALL DISCREPANCIES SHALL BE REFERRED TO THE DESIGNER FOR DECISION BEFORE PROCEEDING WITH THE WORK. ALL DIMENSIONS RELEVANT TO SETTING OUT AND OFF-SITE WORK SHALL BE VERIFIED BY THE CONTRACTOR BEFORE CONSTRUCTION AND FABRICATIONS COMMENCED. THE ENGINEERS DRAWINGS SHALL NOT BE SCALED.

1 FOR REVIEW

26.7.2017

ISSUE	DESCRIPTION	DATE
1	FOR REVIEW	26.7.2017