

DOWLING

PROPERTY



586 Main Road Glendale NSW

3  1  1 

Step into this beautifully renovated gem located in the heart of Glendale! No stone has been left unturned, from internal to external. With floating floorboards throughout, this home is both stylish and practical, offering everything you need for modern living.

Boasting two generously sized bedrooms, both featuring ceiling fans and mirrored robes, plus a versatile home office that could serve as a third bedroom.

The practical kitchen offers plenty of bench and cupboard space, an oven, and a cooktop-perfect for the home cook up.

The living and dining area flows seamlessly into the brand-new back entertainment space. This fully tiled alfresco area is the ultimate spot for entertaining, complete

Price : \$690,000 - \$730,000
Land Size : 391 sqm
View : <https://www.dowlingterrace.com.au/sale/nsw/lake-macquarie-east/glendale/residential/house/8140841>



Liam Higgins
0423 832 732



Kim Hammond
0498 990 064

<https://www.dowlingterrace.com.au>

Measurements are approximate and are to be used only as a guide

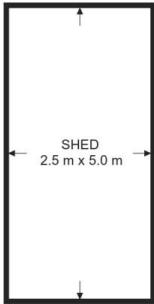
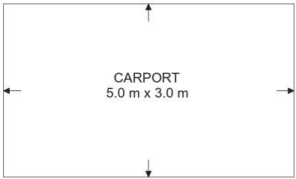
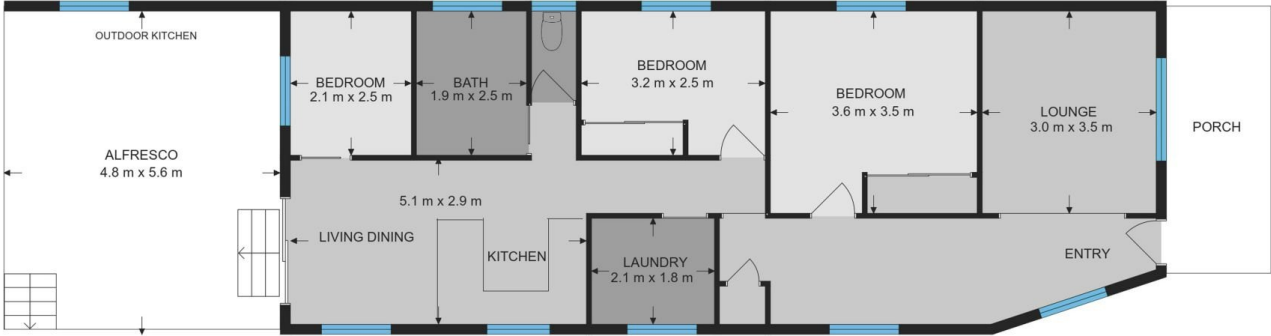

Site Plan
Back



DOWLING
PROPERTY

586 Main Road, Glendale